

参考資料3 敷地測量図

求積表

地番 87-1				
NO	X _n	Y _n	Y _{n+1} -Y _{n-1}	X _n · (Y _{n+1} -Y _{n-1})
X13-1	-116289.207	-2582.451	33.892	-3941273.8036440
X14-1	-116298.718	-2567.870	-4.739	551139.6246020
WK-52	-116328.280	-2587.190	-33.892	3942598.0657600
WK-51	-116318.778	-2601.762	4.739	-551234.6889420
合計				1229.1977760
合計面積				614.5988880
地積				614.59 m ²

地番 88-1				
NO	X _n	Y _n	Y _{n+1} -Y _{n-1}	X _n · (Y _{n+1} -Y _{n-1})
WK-51	-116318.778	-2601.762	17.738	-2063262.4841640
WK-52	-116328.280	-2587.190	11.404	-1326607.7051200
AK23	-116333.127	-2590.358	-17.738	2063517.0067260
UK26	-116323.626	-2604.928	-11.404	1326554.6309040
合計				201.4483460
合計面積				100.7241730
地積				100.72 m ²

地番 89-1				
NO	X _n	Y _n	Y _{n+1} -Y _{n-1}	X _n · (Y _{n+1} -Y _{n-1})
X-12	-116273.711	-2596.253	42.230	-4910238.8155300
X-13	-116284.651	-2579.476	13.802	-1604960.7531020
X13-1	-116289.207	-2582.451	-22.286	2591621.2672020
WK-51	-116318.778	-2601.762	-22.477	2614497.1731060
UK26	-116323.626	-2604.928	-19.944	2319958.3969440
UK27	-116312.685	-2621.706	8.675	-1009012.5423750
合計				1864.7262450
合計面積				932.3631225
地積				932.36 m ²

地番 90-1				
NO	X _n	Y _n	Y _{n+1} -Y _{n-1}	X _n · (Y _{n+1} -Y _{n-1})
X-11	-116262.770	-2613.031	20.765	-2414196.4190500
X-12	-116273.711	-2596.253	-8.675	1008674.4429250
UK27	-116312.685	-2621.706	-42.232	4912117.3129200
UK42	-116301.744	-2638.485	-11.777	1369685.6390880
WK-48	-116294.085	-2633.483	17.233	-2004095.9668050
WK-49	-116302.060	-2621.252	24.697	-2872311.9758200
WK-50	-116282.969	-2608.786	0.237	-27559.0636530
WK-47	-116274.996	-2621.015	-8.232	957175.7670720
WK-46	-116268.875	-2617.018	7.984	-928290.6980000
合計				1199.0386770
合計面積				599.5193385
地積				599.51 m ²

地番 91				
NO	X _n	Y _n	Y _{n+1} -Y _{n-1}	X _n · (Y _{n+1} -Y _{n-1})
WK-47	-116274.996	-2621.015	24.697	-2871643.5762120
WK-50	-116282.969	-2608.786	-0.237	27559.0636530
WK-49	-116302.060	-2621.252	-24.697	2872311.9758200
WK-48	-116294.085	-2633.483	0.237	-27561.6981450
合計				665.7651160
合計面積				332.8825580
地積				332.88 m ²

地番 92-1				
NO	X _n	Y _n	Y _{n+1} -Y _{n-1}	X _n · (Y _{n+1} -Y _{n-1})
X-10	-116240.888	-2646.587	59.009	-6859258.5599920
X-11	-116262.770	-2613.031	29.569	-3437773.8461300
WK-46	-116268.875	-2617.018	-20.792	2417462.4490000
WK-45	-116257.916	-2633.823	-38.244	4446167.7395040
UK43	-116290.803	-2655.262	-38.217	4444285.6182510
K-AK28	-116279.862	-2672.040	8.675	-1008727.8028500
合計				2155.5977830
合計面積				1077.7988915
地積				1077.79 m ²

地番 93				
NO	X _n	Y _n	Y _{n+1} -Y _{n-1}	X _n · (Y _{n+1} -Y _{n-1})
WK-45	-116257.916	-2633.823	38.244	-4446167.7395040
WK-46	-116268.875	-2617.018	12.808	-1489171.7510000
WK-47	-116274.996	-2621.015	-16.465	1914467.8091400
WK-48	-116294.085	-2633.483	-17.470	2031657.6649500
UK42	-116301.744	-2638.485	-21.779	2532935.6825760
UK43	-116290.803	-2655.262	4.662	-542147.7235860
合計				1573.9425760
合計面積				786.9712880
地積				786.97 m ²

地番 116				
NO	X _n	Y _n	Y _{n+1} -Y _{n-1}	X _n · (Y _{n+1} -Y _{n-1})
KY20	-116329.121	-2694.659	-26.324	3062247.7812040
MP12	-116324.730	-2701.383	20.703	-2408270.8851900
KY1	-116282.791	-2673.956	44.207	-5140513.3417370
KY2A	-116293.733	-2657.176	8.939	-1039549.6792870
KY21	-116305.721	-2665.017	-17.883	2079895.2086430
KY22	-116299.153	-2675.059	-29.642	3447339.4932260
合計				1148.5768590
合計面積				574.2884295
地積				574.28 m ²

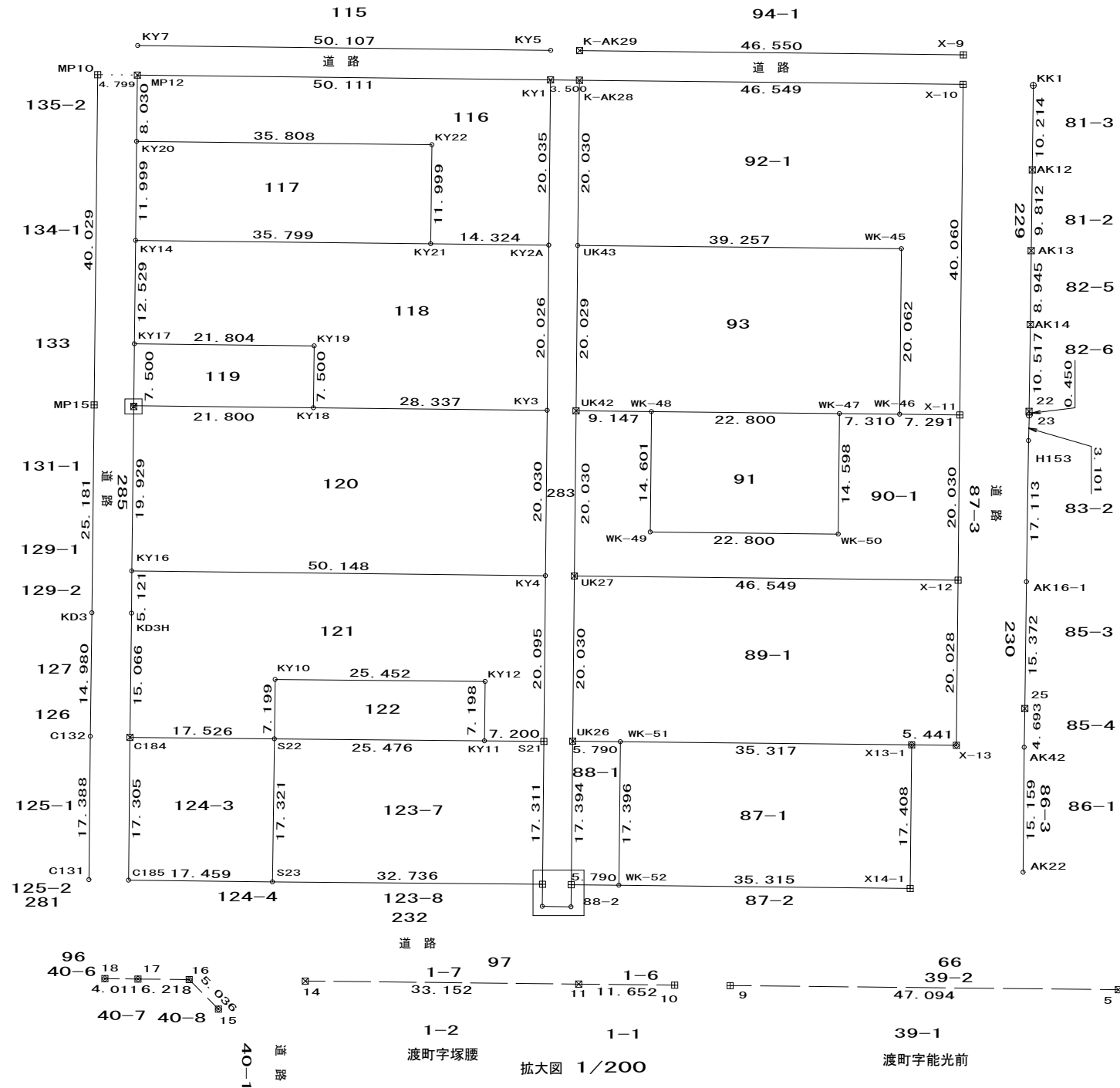

拡大図 1/200

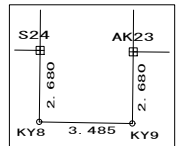

凡例	杭の種類
□	石杭
■	コンクリート杭
⊠	プラスチック杭
⊞	金属標
⊕	鉄
⊖	刻印
○	木杭
▽	現況点
○	計算点

所在	岡崎市筒針町字元流地内
図面の種類	確定図(予定)
縮尺	1 / 500

拡大図 1/50

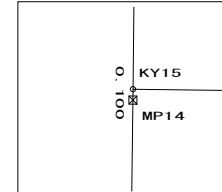

地番 117				
NO	X _n	Y _n	Y _{n+1} -Y _{n-1}	X _n · (Y _{n+1} -Y _{n-1})
KY14	-116335.682	-2684.612	-29.642	3448422.2858440
KY20	-116329.121	-2694.659	9.553	-1111292.0929130
KY22	-116299.153	-2675.059	29.642	-3447339.4932260
KY21	-116305.721	-2665.017	-9.553	1111068.5527130
			合計	859.2524180
			合計面積	429.6262090
			地積	429.62 m ²

地番 118				
NO	X _n	Y _n	Y _{n+1} -Y _{n-1}	X _n · (Y _{n+1} -Y _{n-1})
KY17	-116342.533	-2674.122	-22.426	2609097.6450580
KY14	-116335.682	-2684.612	9.105	-1059236.3846100
KY21	-116305.721	-2665.017	27.436	-3190963.7613560
KY2A	-116293.733	-2657.176	24.619	-2863035.4127270
KY3	-116304.674	-2640.398	1.267	-147358.0219580
KY18	-116328.390	-2655.909	-21.788	2534562.9613200
KY19	-116324.285	-2662.186	-18.213	2118614.2027050
			合計	1681.2284320
			合計面積	840.6142160
			地積	840.61 m ²

地番 119				
NO	X _n	Y _n	Y _{n+1} -Y _{n-1}	X _n · (Y _{n+1} -Y _{n-1})
KY15	-116346.634	-2667.842	-18.213	2119021.2450420
KY17	-116342.533	-2674.122	5.656	-658033.3666480
KY19	-116324.285	-2662.186	18.213	-2118614.2027050
KY18	-116328.390	-2655.909	-5.656	657953.3738400
			合計	327.0495290
			合計面積	163.5247645
			地積	163.52 m ²

地番 120				
NO	X _n	Y _n	Y _{n+1} -Y _{n-1}	X _n · (Y _{n+1} -Y _{n-1})
KY16	-116357.584	-2651.070	-44.138	5135791.0425920
MP14	-116346.689	-2667.758	-16.772	1951366.6679080
KY15	-116346.634	-2667.842	11.849	-1378591.2662660
KY18	-116328.390	-2655.909	27.444	-3192516.3351600
KY3	-116304.674	-2640.398	32.289	-3755361.6187860
KY4	-116315.615	-2623.620	-10.672	1241320.2432800
			合計	2008.7335680
			合計面積	1004.3667840
			地積	1004.36 m ²

地番 121				
NO	X _n	Y _n	Y _{n+1} -Y _{n-1}	X _n · (Y _{n+1} -Y _{n-1})
C184	-116368.650	-2634.186	-22.178	2580823.9197000
KD3H	-116360.384	-2646.782	-16.884	1964628.7234560
KY16	-116357.584	-2651.070	23.162	-2695074.3606080
KY4	-116315.615	-2623.620	44.287	-5151269.6415050
S21	-116326.586	-2606.783	12.910	-1501776.2252600
KY11	-116332.621	-2610.710	-9.958	1158440.2399180
KY12	-116328.691	-2616.741	-19.913	2316453.2238830
KY10	-116350.024	-2630.623	-7.863	914860.2387120
S22	-116353.975	-2624.604	-3.563	414569.2129250
			合計	1655.3312210
			合計面積	827.6656105
			地積	827.66 m ²

地番 122				
NO	X _n	Y _n	Y _{n+1} -Y _{n-1}	X _n · (Y _{n+1} -Y _{n-1})
S22	-116353.975	-2624.604	-19.913	2316956.7041750
KY10	-116350.024	-2630.623	7.863	-914860.2387120
KY12	-116328.691	-2616.741	19.913	-2316453.2238830
KY11	-116332.621	-2610.710	-7.863	914723.3989230
			合計	366.6405030
			合計面積	183.3202515
			地積	183.32 m ²

地番 123-7				
NO	X _n	Y _n	Y _{n+1} -Y _{n-1}	X _n · (Y _{n+1} -Y _{n-1})
S22	-116353.975	-2624.604	-0.586	68183.4293500
KY11	-116332.621	-2610.710	17.821	-2073163.6388410
S21	-116326.586	-2606.783	18.432	-2144131.6331520
S24	-116336.036	-2592.278	-3.341	388678.6962760
S23	-116363.481	-2610.124	-32.326	3761565.8868060
			合計	1132.7404390
			合計面積	566.3702195
			地積	566.37 m ²

地番 124-3				
NO	X _n	Y _n	Y _{n+1} -Y _{n-1}	X _n · (Y _{n+1} -Y _{n-1})
S22	-116353.975	-2624.604	24.062	-2799709.3464500
S23	-116363.481	-2610.124	4.921	-572624.6900010
C185	-116378.091	-2619.683	-24.062	2800289.6256420
C184	-116368.650	-2634.186	-4.921	572650.1266500
			合計	605.7158410
			合計面積	302.8579205
			地積	302.85 m ²

地番 283				
NO	X _n	Y _n	Y _{n+1} -Y _{n-1}	X _n · (Y _{n+1} -Y _{n-1})
KY8	-116337.500	-2590.033	-4.165	484545.6875000
S24	-116336.036	-2592.278	-16.750	1948628.6030000
S21	-116326.586	-2606.783	-31.342	3645907.8584120
KY4	-116315.615	-2623.620	-33.615	3909949.3982250
KY3	-116304.674	-2640.398	-33.556	3902719.6407440
KY2A	-116293.733	-2657.176	-33.558	3902585.0920140
KY1	-116282.791	-2673.956	-14.864	1728427.4054240
K-AK28	-116279.862	-2672.040	18.694	-2173735.7402280
UK43	-116290.803	-2655.262	33.555	-3902137.8946650
UK42	-116301.744	-2638.485	33.556	-3902621.3216640
UK27	-116312.685	-2621.706	33.557	-3903104.7705450
UK26	-116323.626	-2604.928	31.348	-3646513.0278480
AK23	-116333.127	-2590.358	16.815	-1956141.5305050
KY9	-116334.591	-2588.113	0.325	-37808.7420750
			合計	700.6577890
			合計面積	350.3288945
			地積	350.32 m ²

総合計面積	9687.8215590 m ²
-------	-----------------------------

所在	岡崎市筒針町字元流地内
図面の種類	確定図(予定)
縮尺	